

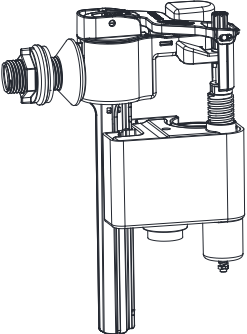

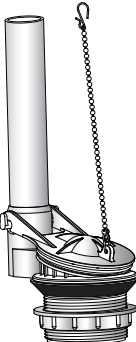

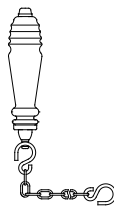
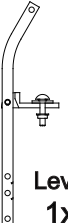

Parts supplied:

 <p>Inlet Valve 1x</p>	 <p>Flush Valve 1x</p>	 <p>Handle 1x</p>	 <p>Lever 1x</p>	 <p>Spring 1x</p>	<div>  <p>Flush Cone 1x</p> </div> <div>  <p>Plastic Washer 1x</p> </div> <div>  <p>Cone Washer 1x</p> </div> <div>  <p>Fixing Nut 1x</p> </div>
		 <p>Cover 2x</p>	 <p>fixing block 1x</p>		

- Please read these instructions carefully to avoid damage to the valves, and to ensure correct installation.
 - Do not use bleach or bleach based cleaning products in the cistern, as these will cause damage to the seals.
- We cannot be held responsible or liable for any failure which results from the use of bleach based products.
- Water temperature range +2C to +45C.
 - Water pressure 0.2 to 8 bar.

1: Inlet Valve installation and adjustment settings

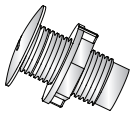
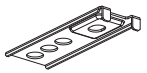
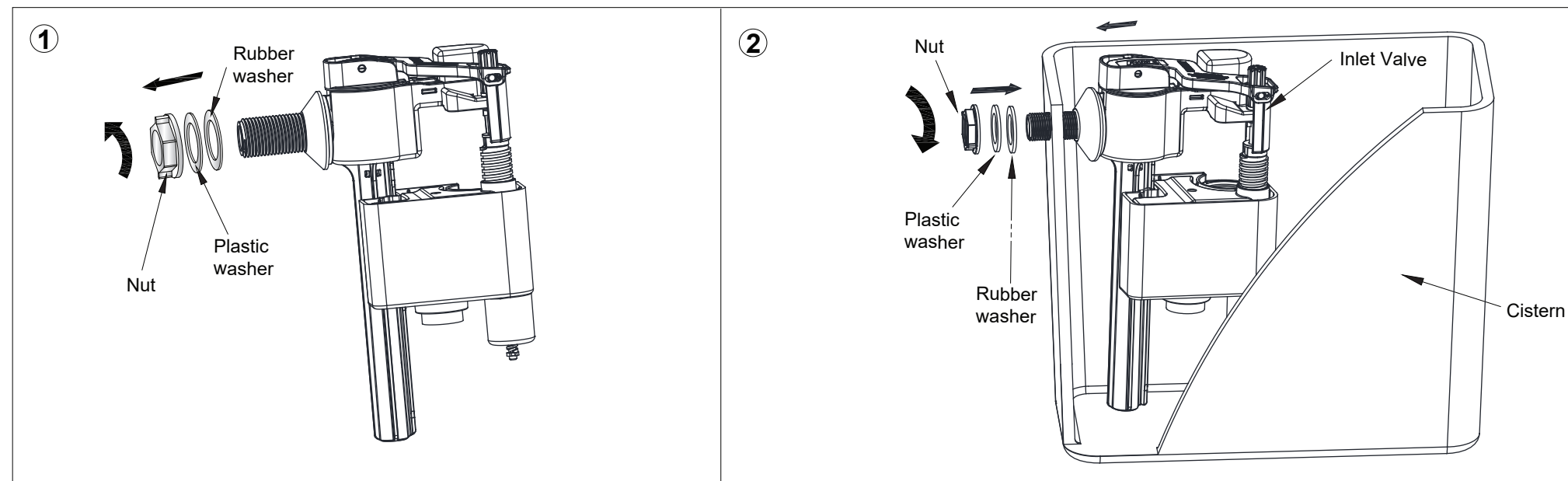

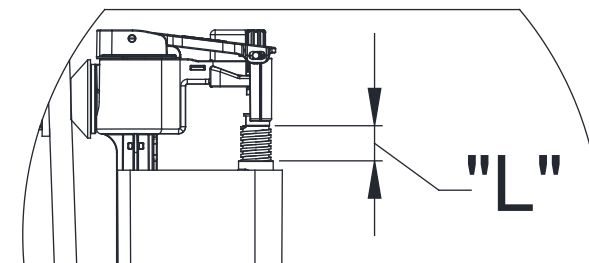
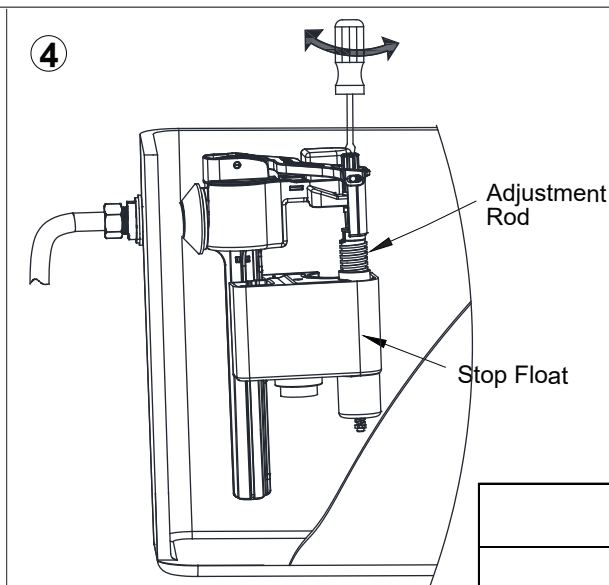
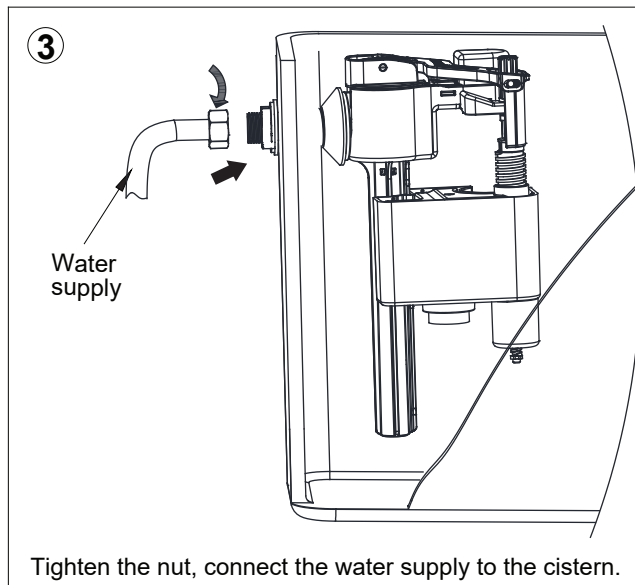

Adjustment the rod:

A: By adjusting clockwise the water level rises and flush volume increases.

B: By adjusting anti-clockwise the water level falls and the flush volume decreases.

Item	L (mm) 6L full flush	L (mm) 4.5L full flush
C28S	47	67

2: Filter cleaning (Please clean periodically)

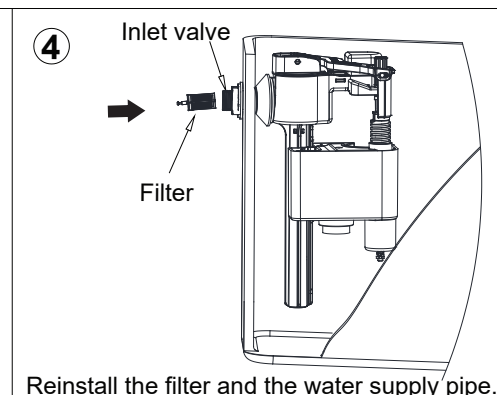
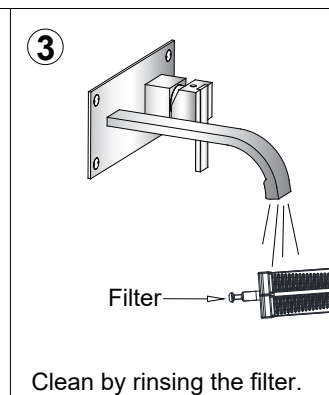
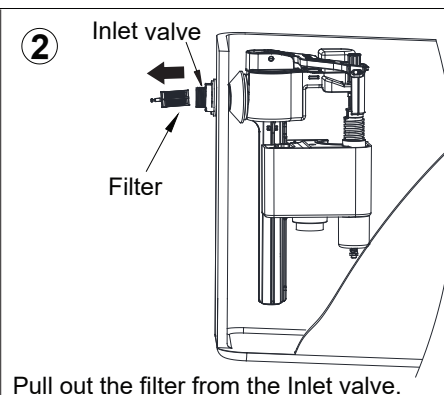
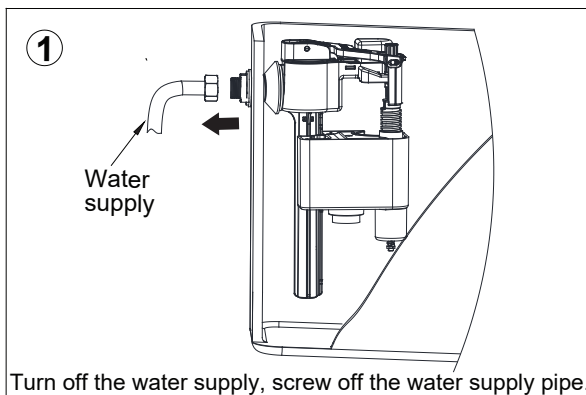

3: Inlet Valve trouble shooting

Problem	Reason	Solution
Incorrect water level	Incorrect adjustment.	Adjust the Water level correctly as per diagram above.
Inlet Valve does not work	Water supply is closed.	Open the water supply
	The filter is blocked.	Clean the filter.
	The Stop Float has been over adjusted beyond its operational range.	Adjust the adjustment rod.
Leakage	The Inlet Valve fixing nut has not been tightened.	Tighten the nut.

Flush Valve Installation And Problem Solving

1: Flush Valve installation

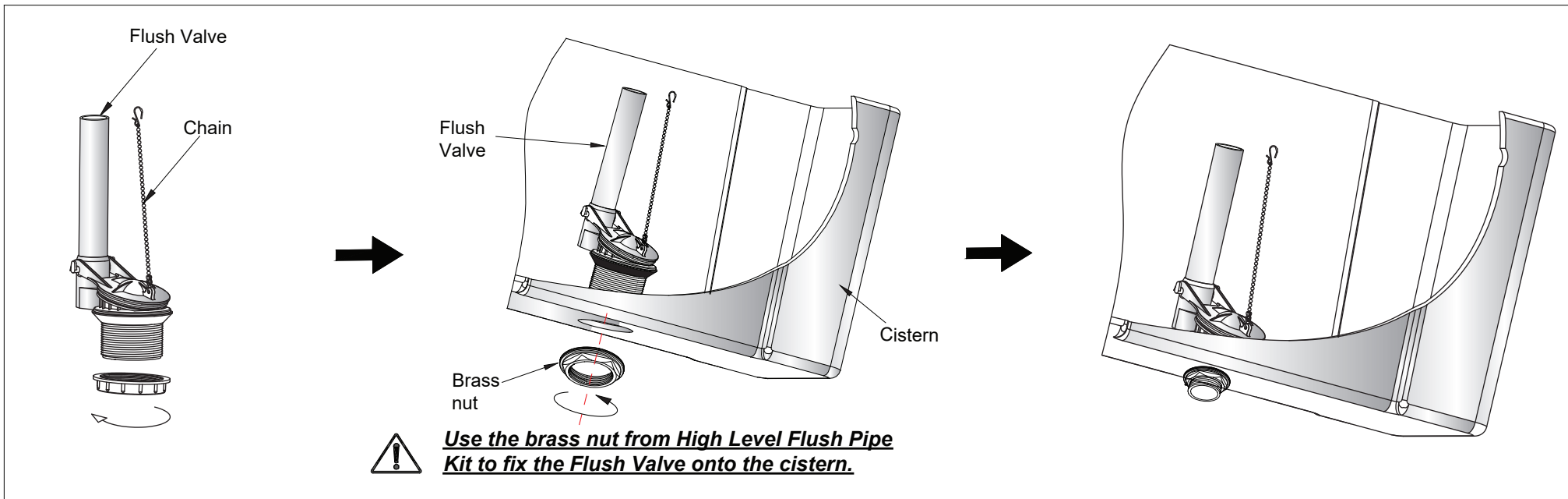

2: Flush Valve Cleaning

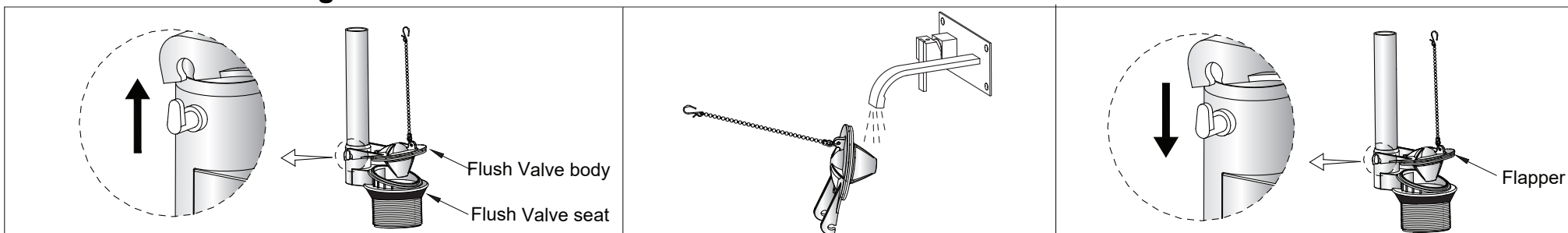

3: Flush Valve trouble shooting

Problem	Reason	Solution
Leakage	1. Incorrect installation. 2. Flush valve body is stuck. 3. Chain is too short. 4. The flapper doesn't adhere to the flush valve seat.	1. Install again according to the correct installation procedure. 2. Unpick and wash flush valve body. 3. Readjust the length of chain. 4. Install again.
No flush, low flush or half flush volume	Chain is too long.	Readjust the length of chain.

Flush Lever Installation

1: Install Flush Lever Onto Cistern

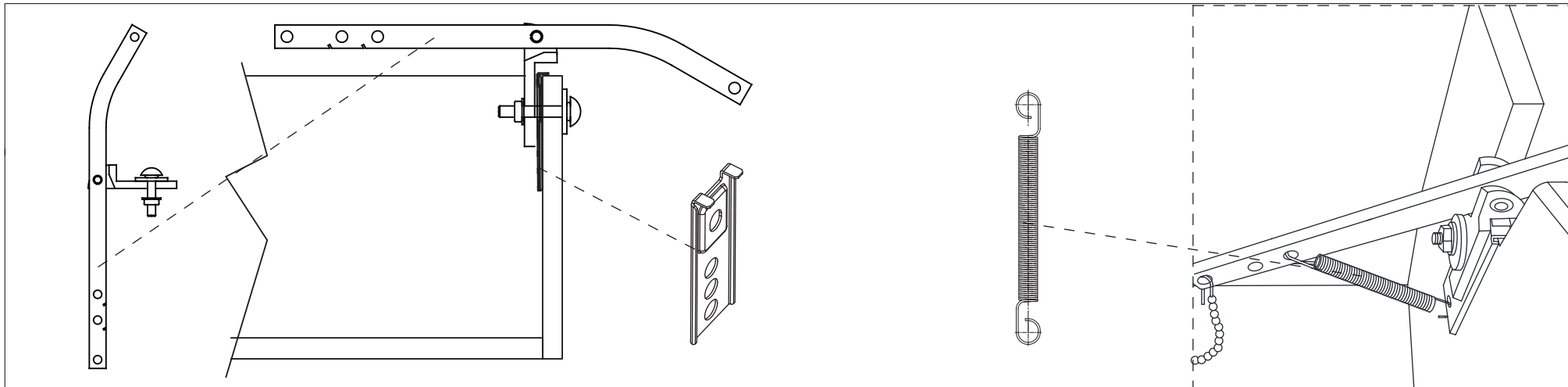

2: Connect Flush valve With Flush Lever

